

[illegible]

FACHADA 03 1/100

[illegible]

FACHADA 04 1/100

Architectural elevation drawing of a building facade (FACHADA 04) at a scale of 1/100. The drawing shows a long, low structure with a series of vertical panels. A staircase is visible on the left side, and a small entrance is marked at the bottom left. Dimensions are provided in meters: total height 2.60m, staircase height 2.50m, and various panel widths and heights (1.20m, 3.50m, 2.60m, 2.90m). A small inset shows a detail of the staircase structure.

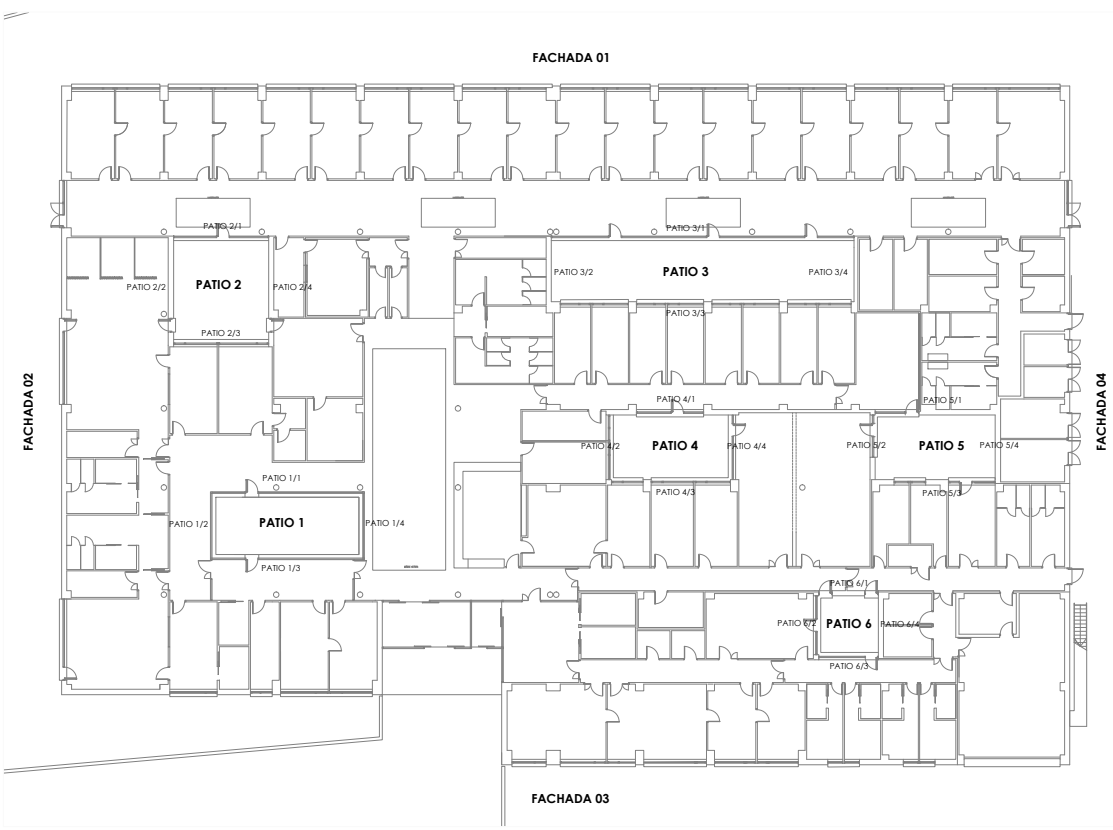

The diagrams illustrate the relationship between patio width and building height. Each section shows a building facade with a patio area above it. The height of the building is consistently 2.50 units. The patio width varies: 9.80 for 1/1, 4.15 for 1/2, 9.80 for 1/3, and 4.15 for 1/4. The solar exterior panel is positioned at a height of 0.50 units from the ground level. The solar exterior is at 0.00 units, and the solar interior is at 0.50 units.

PATIO 02 1/100

PATIO 2/1

PATIO 2/2

PATIO 2/3

PATIO 2/4

[illegible]

The image displays four architectural drawings of patio layouts, each with dimensions and labels for 'salle extérieure' and 'salle intérieure'.

- PATIO 05 1/100:** Shows a rectangular area with a total width of 7.95 and a total height of 2.50. The 'salle extérieure' is 2.80 wide and 1.25 high. The 'salle intérieure' is 1.25 wide and 1.25 high.
- PATIO 5/1:** Shows a rectangular area with a total width of 4.30 and a total height of 2.55. The 'salle extérieure' is 2.80 wide and 1.25 high. The 'salle intérieure' is 1.25 wide and 1.25 high.
- PATIO 5/3:** Shows a rectangular area with a total width of 7.95 and a total height of 2.55. The 'salle extérieure' is 3.10 wide and 1.50 high. The 'salle intérieure' is 1.50 wide and 1.10 high.
- PATIO 5/4:** Shows a rectangular area with a total width of 4.30 and a total height of 2.55. The 'salle extérieure' is 2.80 wide and 1.25 high. The 'salle intérieure' is 1.25 wide and 1.25 high.

FACHADA VENTILADA DE PANEL DE FIBRO-CEMENTO CON BASE DE CELULOSA, ESPESOR 8mm, CON ANCLAJE REMACHADO.
ESTRUCTURA SEGUN FABRICANTE DE PERFIL DE ALUMINIO, CON PIEZAS ESPECÍFICAS.
ARRANQUE DE FACHADA MEDIANTE RODAPIÉ REHUNDIDO DE PANEL EQUITONE PICTURA.
EN BASE A PANEL DE 2500X1220mm Y 8mm DE ESPESOR